

ADAPTER SERIES: : MCX
 CENTER CONDUCTOR END 1: : MALE PIN
 CENTER CONDUCTOR END 2: : MALE PIN
 NOMINAL IMPEDANCE: (OHMS) : 50
 CONTACT CAPTIVATION: : 4.0 LBs.
 FREQUENCY RANGE: : DC TO 6.0 GHz.
 QPL SPECIFICATION: : N/A
 QPL EQUIVALENT: : N/A

MATING CHARACTERISTICS : CECC 22220
 MATING TORQUE : N/A
 MOUNTING TORQUE : N/A
 TEMPERATURE RANGE : -55 / +125 DEGREES C.

ELECTRICAL:
 VSWR MAXIMUM : 1.15 + .025 x F (F IN GHz.)
 INSERTION LOSS MAXIMUM : .05 x \sqrt{FGHz} .
 R.F. LEAKAGE MINIMUM : -60 dB @ 1 GHz.
 D.C. RESISTANCE : 5,000 MOHMS MINIMUM

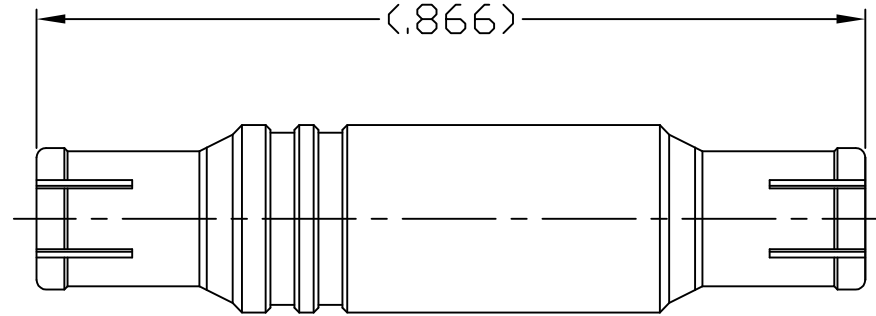

CONFIDENTIAL

ITEM	MATERIALS	FINISHES
BODY	: BRASS PER ASTM-B-16	: GOLD PER ASTM-B-488
INSULATOR	: PTFE PER ASTM-D-1710	: N/A
CONTACT	: BRASS PER ASTM-B-16	: GOLD PER ASTM-B-488

REV.	DCN NUMBER	DATE	APP.
AA	05-1747	7/22/05	DC

SPECIFICATION CONTROL DRAWING

dynawave[®]
 INCORPORATED
 Haverhill, MA. 01835

TITLE
**MCX PLUG TO MCX
 PLUG ADAPTER**

TOLERANCES		
DECIMALS	FRACTIONAL	DEGREES
.X ±.030		X [±] 1°0'
.XX ±.010	± 1/16"	X [±] X' ±15'
.XXX ±.005		

DRAWN: DC DATE: 7/22/05
 APPROVED: DC DATE: 7/22/05

SCALE	CODE IDENT	SHEET
N/A	2J899	1 of 1

DRAWING
 NO. **1100-1515-2400**