

ADAPTER SERIES: : SMP / 2.92mm
 CENTER CONDUCTOR END 1: : MALE PIN
 CENTER CONDUCTOR END 2: : MALE PIN
 NOMINAL IMPEDANCE: (OHMS) : 50
 CONTACT CAPTIVATION: : 6.0 LBS.
 FREQUENCY RANGE: : DC TO 40 GHz.
 QPL SPECIFICATION: : N/A
 QPL EQUIVALENT: : N/A

MATING CHARACTERISTICS : MIL-STD-348-326.3
 : IEEE 287
 INSERTION FORCE : 10.0 LBS. MAX SMP
 WITHDRAWAL FORCE : 2.0 LBS. MIN SMP
 MATING TORQUE 2.92mm : 7 TO 10 POUND INCHES
 MOUNTING TORQUE : N/A
 TEMPERATURE RANGE : -25 / +100 DEGREES C.

ELECTRICAL:
 MAX. VSWR 1.0 TO 26.5 GHz. : 1.05 + .005 x FGHz
 MAX. VSWR 26.6 TO 40.0 GHz. : 1.05 + .010 x FGHz.
 INSERTION LOSS MAXIMUM : .045 x $\sqrt{\text{FGHz}}$
 R.F. LEAKAGE MINIMUM : -100 dB - F (F IN GHz.)
 D.C. RESISTANCE : 5,000 MOHMS MINIMUM

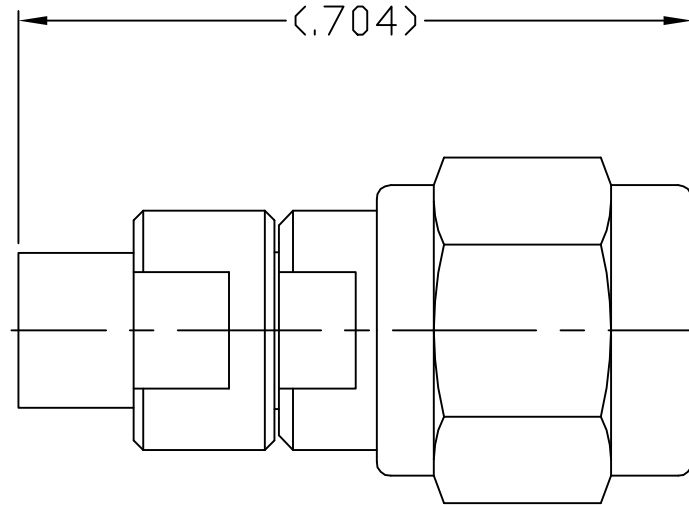

| ITEM | MATERIALS | FINISHES |
|----------------|-----------------------------------|-------------------------|
| BODIES | : 303 STAINLESS PER ASTM-A-582 | : PASSIVATE PER QQ-P-35 |
| COUPLING NUT | : 303 STAINLESS PER ASTM-A-582 | : PASSIVATE PER QQ-P-35 |
| RETAINING RING | : COPPER, BERYLLIUM PER ASTM-B194 | : N/A |
| BEAD | : PLASIC COMPOSIT | : N/A |
| INSULATOR | : PTFE PER ASTM-D-1710 | : N/A |
| CONTACT | : COPPER, BERYLLIUM PER ASTM-B196 | : GOLD PER ASTM-B-488 |

| REV. | DCN NUMBER | DATE | APP. |
|------|------------|--------|------|
| AA | 04-1431 | 4/5/04 | DC |
| | | | |
| | | | |
| | | | |
| | | | |
| | | | |

SPECIFICATION CONTROL DRAWING



TITLE
**SMP MALE, (LIMITED
 DETENT) TO 2.92 mm
 MALE, ADAPTER**

| DECIMALS | FRACTIONAL | DEGREES |
|------------|------------|-----------|
| .X ±.030 | | X°10' |
| .XX ±.010 | ± 1/16" | X°X' ±15' |
| .XXX ±.005 | | |

| | | |
|--------------|------------|--------------|
| DRAWN: DC | | DATE: 4/5/04 |
| APPROVED: DC | | DATE: 4/5/04 |
| SCALE | CODE IDENT | SHEET |
| N/A | 2J899 | 1 of 1 |

DRAWING
 NO. **1107-2194-6250**