

CONNECTOR SERIES: : SSMA
 CENTER CONTACT: : NONE
 NOMINAL IMPEDANCE: (OHMS) : N/A
 CABLE ACCOMMODATION: : N/A

CONTACT CAPTIVATION: : N/A
 CABLE ATTACHMENT: : N/A
 CONTACT ATTACHMENT: : N/A
 FREQUENCY RANGE: : N/A
 QPL SPECIFICATION: : N/A
 QPL EQUIVALENT: : N/A

MATING CHARACTERISTICS : MIL-STD-348-319.1
 MATING TORQUE : 5 TO 8 POUND INCHES
 MOUNTING TORQUE : N/A
 TEMPERATURE RANGE : -65 / +165 DEGREES C.

ELECTRICAL:
 VSWR MAXIMUM : N/A
 INSERTION LOSS MAXIMUM : N/A
 R.F. LEAKAGE MINIMUM : N/A
 INSULATION RESISTANCE : N/A
 D.W.V. : N/A

RoHS
 COMPLIANT

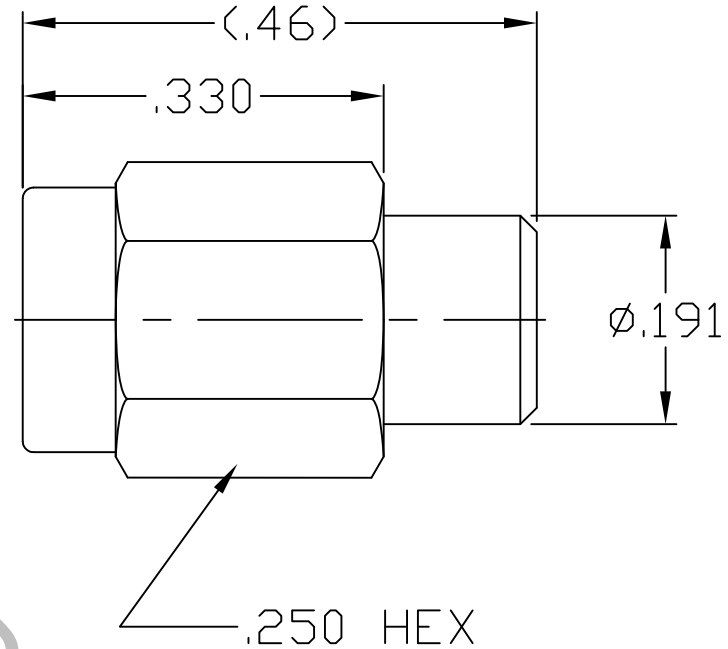

ITEM	MATERIALS	FINISHES
BODY	: 303 STAINLESS PER ASTM-A-582 TYPE 303, COND. A	: PASSIVATE PER AMS 2700 TYPE 2, CLASS 4
NUT	: 303 STAINLESS PER ASTM-A-582 TYPE 303, COND. A	: PASSIVATE PER AMS 2700 TYPE 2, CLASS 4
RETAINING RING	: COPPER, BERYLLIUM PER ASTM B197/B	: N/A
GASKET	: SILICONE RUBBER	: N/A

REV.	DCN NUMBER	DATE	APP.
AA	05-1437	4/5/05	TS
AB	05-2280	12/5/05	DC
AC	11-1467	5/18/11	BC
AD	13-1664	5/3/13	TS

SPECIFICATION CONTROL DRAWING

dynawave
 INCORPORATED
 Haverhill, MA. 01835

TITLE
**SSMA MALE CAP FOR
 FEMALE CONNECTORS**

DECIMALS	TOLERANCES FRACTIONAL	DEGREES
.X ±.030		X°±1'0"
.XX ±.010	± 1/16"	X°X' ±15'
.XXX ±.005		

DRAWN: TS		DATE: 4/5/05
APPROVED: DC		DATE: 4/5/05
SCALE	CODE IDENT	SHEET
N/A	2J899	1 of 1

DRAWING
 NO. **9200-0090-6200**