

CONNECTOR SERIES: : SMA  
 CENTER CONTACT: : FEMALE SOCKET  
 NOMINAL IMPEDANCE: (OHMS) : 50  
 CABLE ACCOMMODATION: : RG-405  
 : Ø.085 S/R  
 : T-FLEX-405  
 CONTACT CAPTIVATION: : N/A  
 CABLE ATTACHMENT: : SOLDER  
 CONTACT ATTACHMENT: : SOLDER  
 FREQUENCY RANGE: : DC TO 6.0 GHz.  
 QPL SPECIFICATION: : N/A  
 QPL EQUIVALENT: : N/A

MATING CHARACTERISTICS : COMMERCIAL  
 MATING TORQUE : 5 TO 7 POUND INCHES  
 MOUNTING TORQUE : N/A  
 TEMPERATURE RANGE : -55 / +125 DEGREES C.

ELECTRICAL:  
 VSWR MAXIMUM :  $1.06 \times F^{.05}$  (F IN GHz.)  
 INSERTION LOSS MAXIMUM :  $.040 \sqrt{F}$  GHz.  
 R.F. LEAKAGE MINIMUM : -100 dB  
 INSULATION RESISTANCE : 5,000 MEGOHMS MIN.  
 D.W.V. : 750 VRMS MAX.

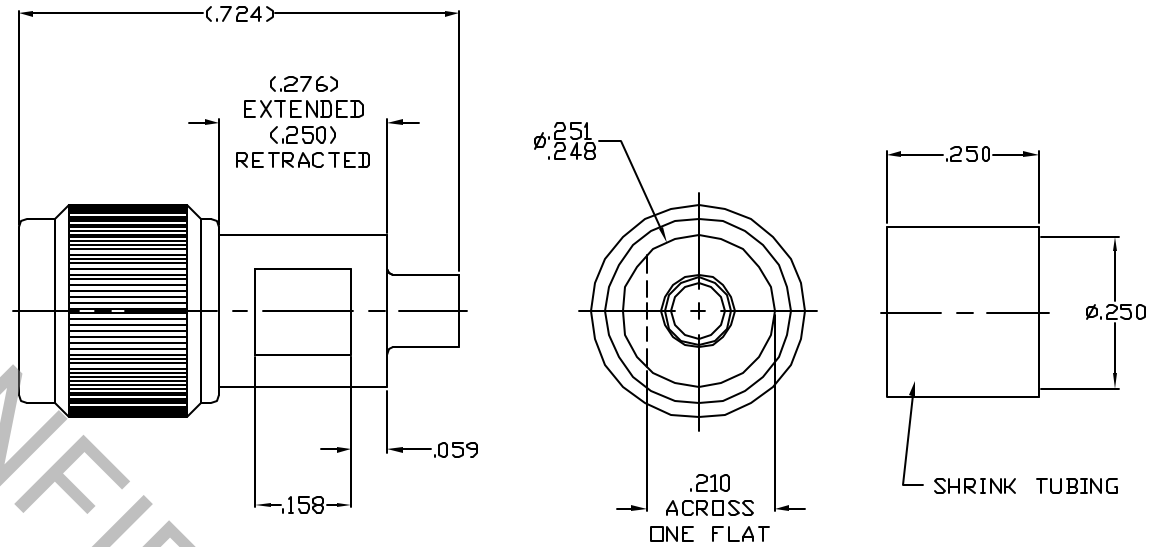

ITEM	MATERIALS	FINISHES
BODY	: BRASS PER ASTM-B-16	: NICKEL PER QQ-N-290
NUT	: BRASS PER ASTM-B-16	: NICKEL PER QQ-N-290
NUT RING	: COPPER, BERYLLIUM PER ASTM-B194	: N/A
GASKET	: SILICONE RUBBER	: N/A
INSULATOR	: PTFE PER ASTM-D-1710	: N/A
CONTACT	: COPPER, BERYLLIUM PER ASTM-B196	: GOLD PER ASTM-B-488

REV.	DCN NUMBER	DATE	APP.
AA	04-1766	6/17/04	DC
AB	04-1784	6/22/04	DC

## SPECIFICATION CONTROL DRAWING



**TITLE**  
**SMA PLUG, POLARIZED,**  
**DIRECT SOLDER, Ø.085**  
**SEMI-RIGID**

DECIMALS : .X ±.030  
 : .XX ±.010  
 : .XXX ±.005  
 TOLERANCES FRACTIONAL : ± 1/16"  
 DEGREES : X° ± 1°  
 : X°X' ± 15'

DRAWN: DC		DATE: 6/17/04	
APPROVED: DC		DATE: 6/17/04	
SCALE	CODE IDENT	SHEET	
N/A	2J899	1 of 1	

**DRAWING**  
**NO. 9800-8520-2700**