

# SPECIFICATION CONTROL DRAWING

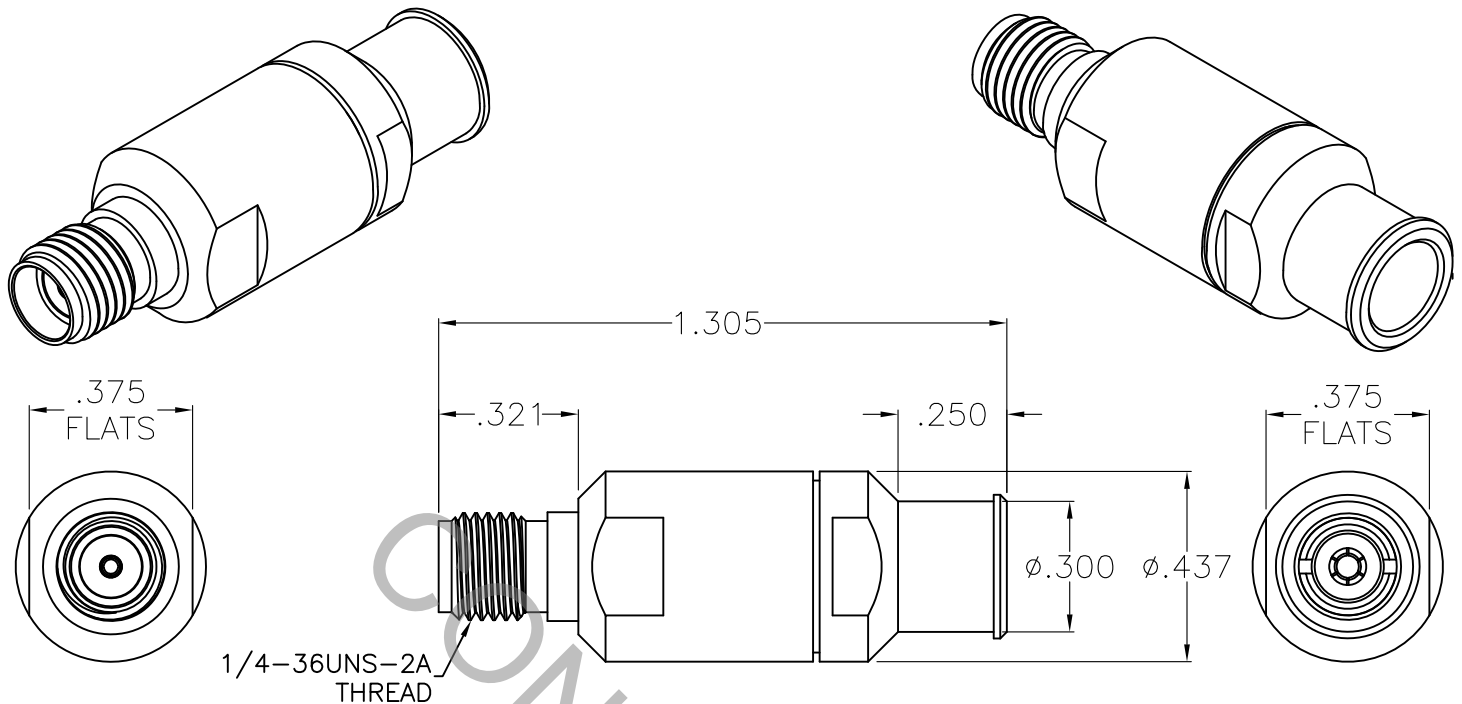

1. MATING INTERFACE DIMENSIONS Per MIL-STD-348 Fig. 310.2 (SMA JACK).

## 2. ELECTRICAL

|   |       |                    |
|---|-------|--------------------|
| FREQUENCY RANGE GHz                         | _____ | DC TO 26.5 GHz     |
| VSWR (MAX) *                                | _____ | 1.05 + .005 x FGHz |
| INSERTION LOSS (dB MAX) *                   | _____ | .04 dB x √FGHz     |
| NOMINAL IMPEDANCE (OHMS)                    | _____ | 50                 |
| VOLTAGE RATING (MAX. VRMS)                  | _____ | 333                |
| RF LEAKAGE (MIN. dB DOWN)                   | _____ | -100 dB - FGHz     |
| TEMPERATURE RATING (DEGREES CENTIGRADE)     | _____ | -65°C TO + 165°C   |
| DIELECTRIC WITHSTANDING VOLTAGE (MAX. VRMS) | _____ | 1,000              |
| INSULATION RESISTANCE (MIN. MEGOHMS)        | _____ | 5,000              |
| CONTACT RESISTANCE                          |       |                    |
| • CENTER CONTACT (MAX. MILLIOHMS)           | _____ | 6.0                |
| • OUTER CONTACT (MAX. MILLIOHMS)            | _____ | 2.0                |

\* TERMINATED IN A 50 OHM LOAD

**RoHS**  
COMPLIANT

| REV. | DCN NO. | DATE    | APP. | DIMENSIONS ARE IN INCHES<br>TOLERANCES |              |                             | CABLE INCORPORATED<br>HAVERHILL, MA 01835                             |
|------|---------|---------|------|--|--------------|-----------------------------|---|
|      |         |         |      | DECIMALS                               | FRACTIONAL   | ANGULAR                     |   |
| AA   | 13-1048 | 1/14/13 | DC   | .X ± .030<br>.XX ± .010<br>.XXX ± .005 | ± 1/64       | X ° ± 1° 0'<br>X ° X' ± 15' |   |
| AB   | 13-1532 | 4/12/13 | DC   |  |              |                             |   |
|      |         |         |      | DRAWN RMS                              | DATE         | 1/11/13                     | TITLE<br>SMA JACK, SOLDER<br>CLAMP, PLUG-IN CONTACT<br>DF126 LOW LOSS |
|      |         |         |      | APPROVED DC                            | DATE         | 1/14/13                     |   |
|      |         |         |      | CODE IDENT.<br>6DZL5                   | SHEET 1 OF 2 | DWG.<br>NO. 9900-126H-6240  |   |

# SPECIFICATION CONTROL DRAWING

## 3. MECHANICAL

### CAPTIVATION-CENTER CONTACT

MAX AXIAL FORCE \_\_\_\_\_ 6.0 LBS.

MAX RADIAL TORQUE \_\_\_\_\_ N/A

### CENTER CONTACT AXIAL FORCES

● INSERTION (MAX OUNCES) \_\_\_\_\_ INTERFACE 32.0

● WITHDRAWAL (MIN. OUNCES) \_\_\_\_\_ INTERFACE 2.0

CONNECTOR ENGAGEMENT/DISENGAGEMENT (MAX LBS.) \_\_\_\_\_ 2.0

CONNECTOR DURABILITY (MIN. CYCLES) \_\_\_\_\_ 500

RECOMMENDED MATING TORQUE \_\_\_\_\_ N/A

## 4. ENVIRONMENTAL

THERMAL SHOCK \_\_\_\_\_ MIL-STD-202, METHOD 107, COND. B ( -65° c TO + 165° c )

SHOCK \_\_\_\_\_ MIL-STD-202, METHOD 213, COND. I (100 G's)

VIBRATION \_\_\_\_\_ MIL-STD-202, METHOD 204, COND. D (20 G's)

MOISTURE RESISTANCE \_\_\_\_\_ MIL-STD-202, METHOD 106, LESS STEP 7b

CORROSION \_\_\_\_\_ MIL-STD-202, METHOD 101, COND. B (48 HOURS)

BAROMETRIC PRESSURE (ALTITUDE) \_\_\_\_\_ MIL-STD-202, METHOD 105, COND. C ( 70,000 FT. ) ( 250 VRMS )

## 5. MATERIAL

BODY, PRESS SLEEVE & CLAMP NUT \_\_\_\_\_ STAINLESS STEEL PER ASTM-A-582, TYPE 303, COND. A

CONTACTS \_\_\_\_\_ BERYLLIUM COPPER PER ASTM-B-196/B, 196M-03, COPPER ALLOY No. UNS-C17300, TEMPER TD04.

INTERFACE INSULATOR \_\_\_\_\_ TEFLON PER ASTM-D-1710-02, TYPE 1, GRADE 1, CLASS B.

REAR INSULATOR \_\_\_\_\_ CROSS LINKED POLYETHYLENE (400°).

SOLDER SLEEVE \_\_\_\_\_ BRASS PER ASTM-B-16, TEMPER H02, ALLOY C36000.

O-RING \_\_\_\_\_ SILICONE RUBBER PER ZZ-R-765.

## 6. FINISH

BODY, PRESS SLEEVE & CLAMP NUT \_\_\_\_\_ PASSIVATE PER AMS 2700, TYPE 2, CLASS 4.

SOLDER SLEEVE \_\_\_\_\_ GOLD PER ASTM-B-488, TYPE I, CODE C, CLASS 1.27  
(.000050 MIN. THK.) OVER NICKEL PER SAE AMS QQ-N-290, CLASS 1  
(.000150 MIN. THK.) OVER COPPER PER AMS 2418 (.000010 MIN. THK.)

CONTACTS \_\_\_\_\_ GOLD PER ASTM-B-488, TYPE I, CODE C, CLASS 0.75  
(.000030 MIN. THK.) OVER NICKEL PER SAE AMS QQ-N-290, CLASS 1  
(.000050 MIN. THK.) OVER COPPER PER AMS 2418 (.000010 MIN. THK.)

INSULATORS & O-RING \_\_\_\_\_ N/A